

# OPERATING INSTRUCTIONS

## M300 SV (SimonsVoss / G2)

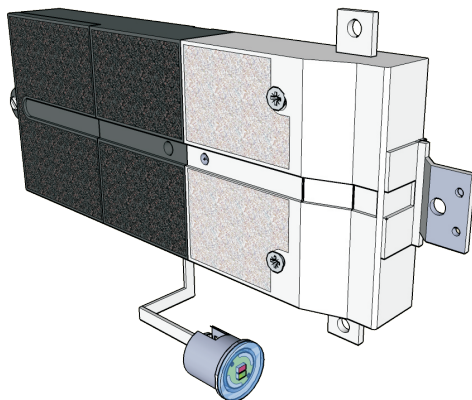

### Contents

General description and mode of operation / Information on operation and care	Page 2
Components needed / pack contents	Page 3
Getting started, changing batteries, function check	Page 4
Advice on installation	Page 5
Advice on removal and technical information	Page 6
Light indicators and signals	Page 7

### Safety precautions

- The bolts can produce a maximum force of 5-10 N. Exceeding this load may permanently damage the system.
- Do not press the extended main bolt back into the casing by mechanical means. This may cause damage to the lock motor.
- On changing the batteries, ensure correct battery polarity and position!
- Dispose of spent batteries in the proper manner.
- Do not heat batteries, take them apart or short-circuit them.
- Never throw batteries into fire.
- The batteries must not be charged.
- Keep batteries out of children's reach.
- Any person swallowing batteries must seek immediate medical advice.
- Damaged and/or leaking batteries may cause acid burns and / or poisoning.

## General description

The M300 electronic locking system is an electronic furniture lock. It is intended for indoor use in the home and office. Using the system in applications for which it is not intended may result in irreparable damage to it and render any claims null and void. The user manual tells you how to install and operate the M300 system in the proper manner. To program the furniture lock, you will need the management software as well as the requisite hardware from SimonsVoss Technologies AG in Munich. The M300 system can be tailored to your personal requirements as it is very easy to use. It can be upgraded from a stand-alone system into a complex, convenient locking system and integrated into existing locking systems from SimonsVoss Technologies AG.

Wording and graphics have been prepared for you with care. We are, however, unable to accept any liability for any errors that may nevertheless have occurred. Copyright 2014 by LEHMANN Vertriebsgesellschaft mbH, D-32429 Minden. All rights reserved.

These instructions must not be reproduced in any way (print, photocopy, microfilm or other process) or processed, duplicated or distributed using electronic systems either in whole or in part without written consent from LEHMANN Vertriebsgesellschaft mbH.

The scope of items included by the manufacturer in the system as well as technical specifications are subject to change without notice.

## Operating description

The M300 electronic locking system provides you with a convenient means of locking and unlocking your furniture electronically. The 300 system allows you to issue selective access authorisations so that only authorised personnel is given access to specific items of furniture. As a result, entire locking systems with different access levels can be configured without a problem.

Each electronic control unit in the M300 system works autonomously, without being connected by cable to other

control electronics or the power supply system. You can program different transmitters with ease in each electronic control unit. In normal operation, the control electronics only respond to the transponders programmed.

**Please note: The distance between the furniture locks must be at least 50 cm.**

To operate the system, you will also need a transponder from SimonsVoss AG that is already in your possession or which you may purchase from your supplier or retailer.

### Note:

Our locks and locking systems can basically be used together with mechanisms made by other manufacturers, but their compatibility must be checked by the processor in each individual case. We cannot accept any liability for damage or losses due to incompatibility.

## Advice on operation and care

- Do not pour any liquids into or over any of the system's components and never immerse the components in liquids.
- Transmission / reception range as well as reception quality may be affected by the building's structure, sources of electronic interference or superimposed frequencies.
- The receiver should not be exposed to direct sunlight.
- Clean the system with a clean, soft, damp cloth only.
- Do not use any cleaning products containing abrasives or solvents, such as glass, thinner, alcohol, benzene or ammonia, as they may react adversely with the enclosure.
- Treating any of the electronic and mechanical components improperly or in any way other than described in this user manual may lead to malfunctions.

## Components needed / pack contents

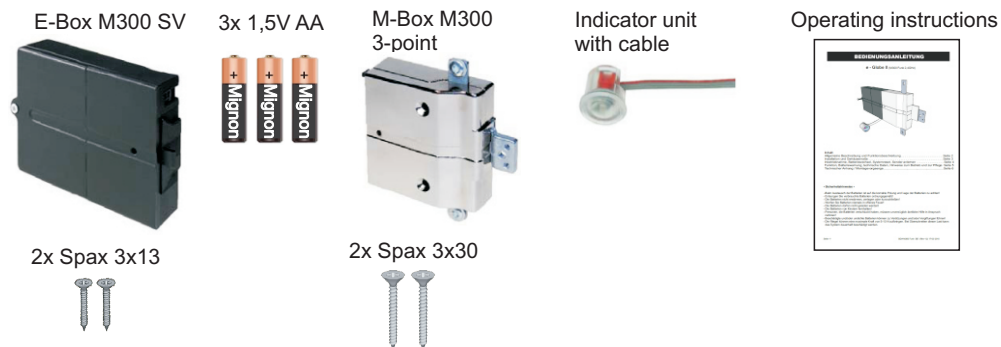

## System components

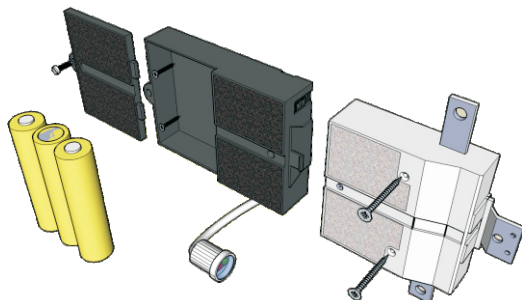

## Dimensions

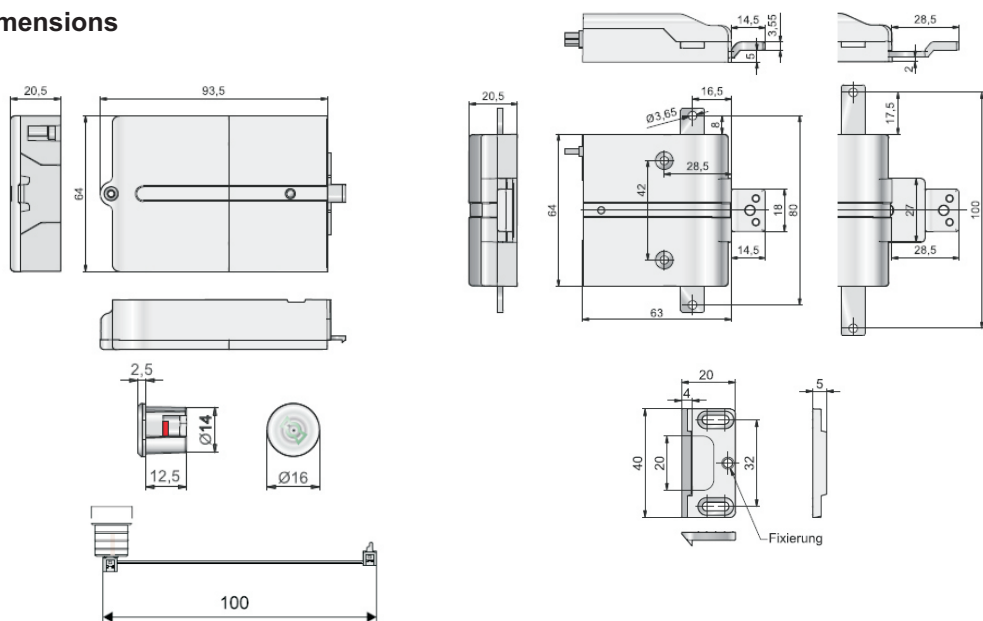

## Getting started / installation

The motor unit, electronics and indicator unit are not interconnected on leaving the factory. To obtain a functional unit, please carry out steps 1 to 3 (see below) one after the other. After establishing proper working order, disconnect the indicator unit (picture 2) from the system again so that the system can easily be installed in furniture.

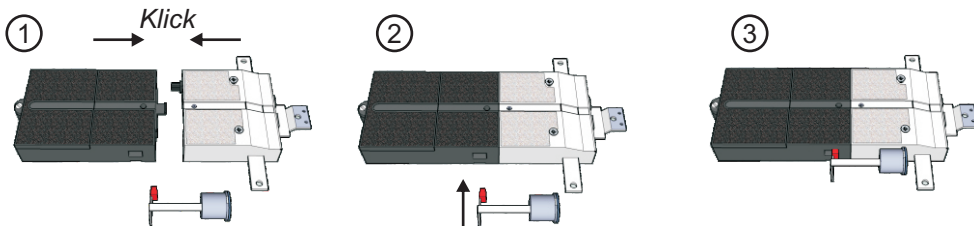

Before installing the system, insert the batteries into the control electronics and program the furniture lock as described in the system manual from SimonsVoss AG. After programming, make sure the system works properly.  
Only install the furniture lock in furniture in an unlocked state.

## Inserting / changing batteries

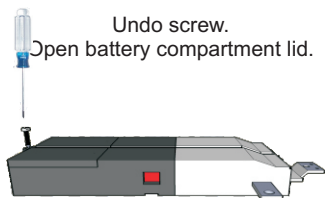

Battery type:  
LR6, AA, alkaline

Change batteries.  
Make sure they are fitted the right way round.  
Close lid.  
Fit fixing screw.

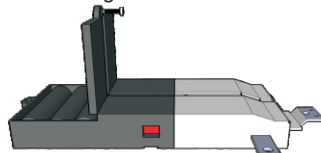

**NOTE:** NiCd, NiMH or other rechargeable batteries as well as zinc-carbon or lithium batteries must not be used.

## Checking for proper operation with an authorised transponder

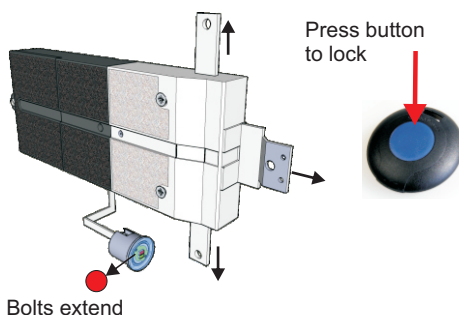
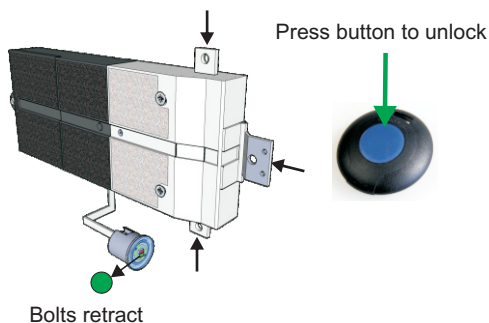

## Advice on installation

This M300 is a motor-driven lock with 3-point locking system. This means that three bolts simultaneously move out of the casing. The two side push bolts are normally connected to push bars. This makes it possible to re-position the locking points. (See installation drawing). The accessories required (push bars, bar guides, striker plates and fixing material) are not included in the set and may be obtained from your fittings retailer. To determine push bar lengths, please use the length calculation method shown in the drawing. This example shows a side-hung door for furniture.

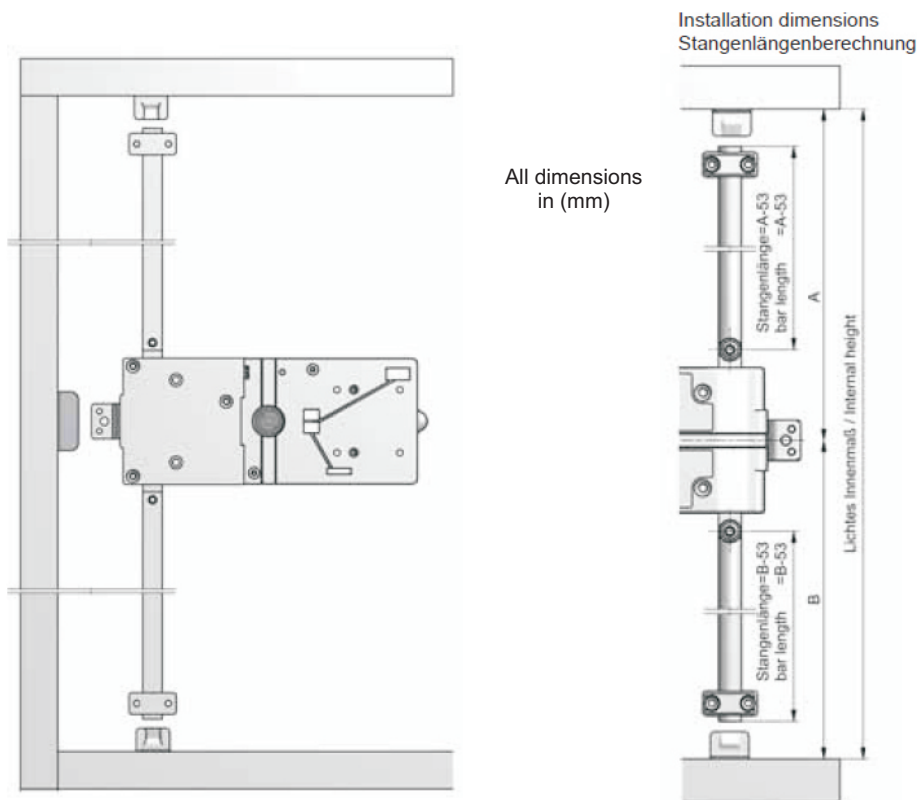

The indicator unit should be installed in such a way as to provide a good line of vision. If you install the indicator unit physically separated from the control electronics, the cable connecting these system components must not be longer than 1 m. Please refer to the fitting instructions from the manufacturer of your furniture for the correct way to attach the M300 system to your furniture. If you have any questions concerning system installation, contact a firm of cabinetmakers or your supplier before commencing installation.

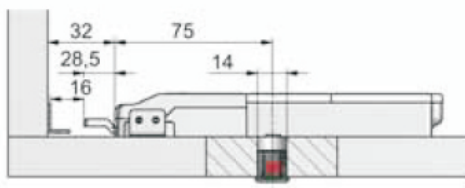

## Advice on removing the M300.

At some time or other it may be necessary to remove the M300. To do this, please proceed as follows:

1. Remove the fixing screws from the motor unit.
2. Release the motor unit and electronics as shown and described below.
3. Open the battery compartment lid, take out the batteries and remove the fixing screws.

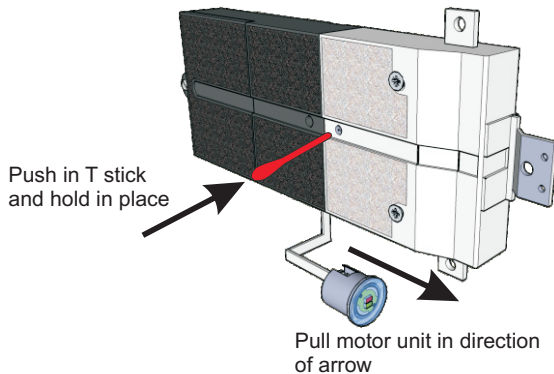

## Technical specifications

To operate the system there must be a line of vision between transponder and receiver.

The distance between the furniture locks must be at least 50 cm.

Frequency: 25KHz. Be sure to observe national legislation on permissible wireless frequencies.

Reach: approx. 30 cm. Transmission/reception range may be affected by the building's structure. To program and start the system please refer to the system manual from Firma SimonsVoss Technologies AG

Power supply for control electronics: battery type: 3x AA mignon cell, alkaline 1.5V.

NiCd, NiMH or other rechargeable batteries as well as zinc-carbon or lithium batteries must not be used.

Temperature range: operation = +5 °C to +40 °C in 30% to 80% relative air humidity, non-condensing.

In storage = -25 °C to +70 °C in 30% to 80% relative air humidity, non-

condensing.

Mechanical load limits:

The front main bolt has a maximum thrust of 10N.

The two side push bolts have a maximum thrust of 5N each when evenly loaded.

**All other aspects are subject to the technical information and regulations issued by SimonsVoss Technologies AG in Munich.**

Light indicators and signals

- flashing
- flashing
- lit

Light indicators in normal operation on locking and unlocking.

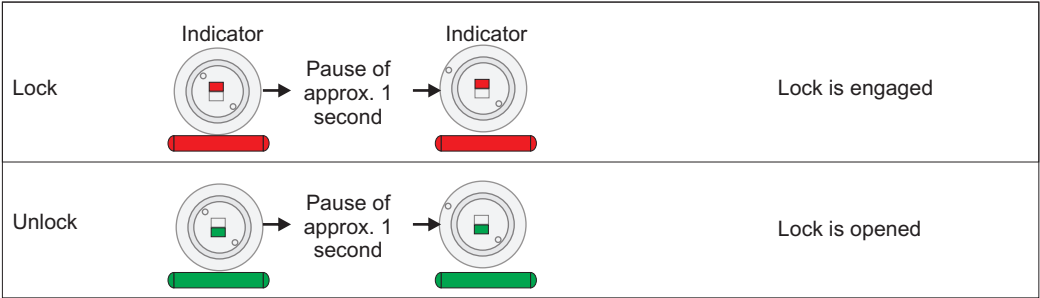

Warning indicators on unlocking

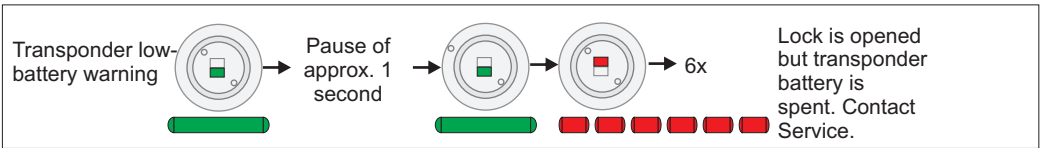

Warning indicators on locking

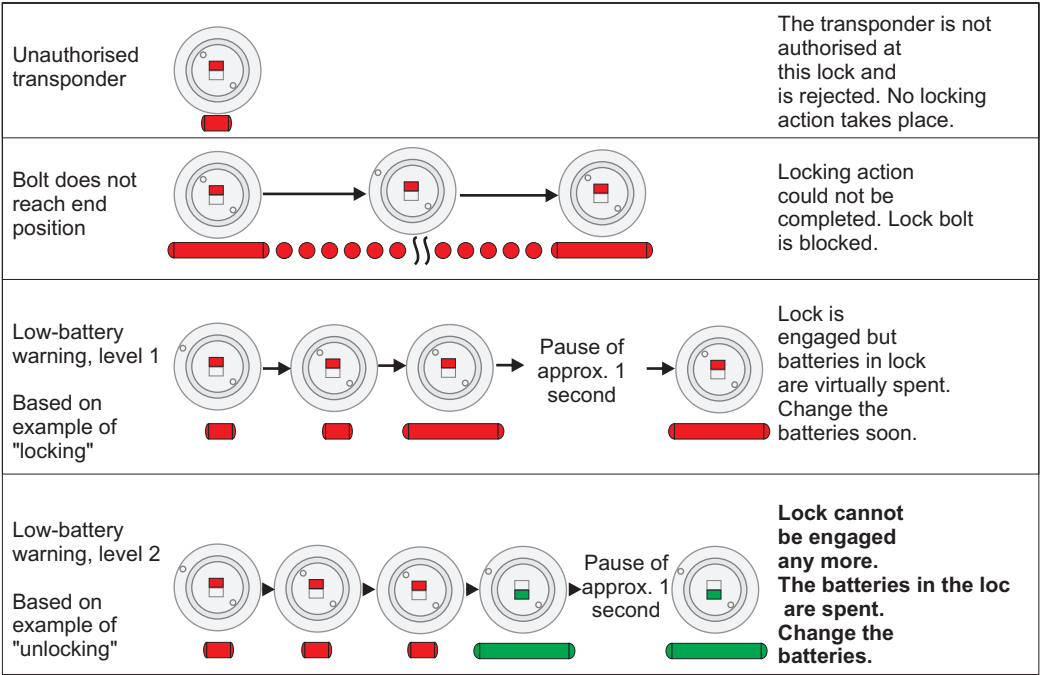

LEHMANN Vertriebsgesellschaft mbH & Co.KG  
Postfach 2620 , D-32429 Minden