

Product catalogue

Intelligent solutions for SMEs

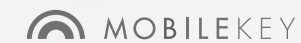



Keyless locking is a conscience decision for greater convenience and security.

Locking and unlocking cars with electronic remote control keys has long been standard practice. With MobileKey from SimonsVoss, you can now apply this principle to doors.

Specifically designed for small and medium-sized companies, this innovation provides you with state-of-the-art technology. In MobileKey systems, a digital transponder, a PIN code keypad or your smartphone replace the trusty key. You use electronic door cylinders instead of mechanical ones. You can fit them easily yourself in minutes with no cabling or drilling required. You configure the system with the help of a free web app and your new locking system is then ready to use!

This well-designed, all-inclusive solution is suitable for up to 20 doors and 100 users. The MobileKey system is extremely affordable and is also inexpensive to run.

MobileKey is the latest newly developed product from SimonsVoss. Based near Munich, the company is a world technology leader in electronic locking and access control systems.

Digital transponders and door cylinders instead of mechanical keys and locks. The future of locking is coming to you.

With MobileKey,
perfect access control is
just a few clicks away.
Web-based, obviously.

01. Web app

MobileKey is set up and managed using an app. The app can be run on all internet-ready devices such as PCs, tablet PCs, Macs or smartphones. Just a few clicks and you can specify who has which access authorisations. Simple as that and change them whenever you like.

02. SimonsVoss server

The web app data are transmitted to the SimonsVoss server, where they are applied as a locking plan and then sent back to the web app. Everything is automatic – you don't need to do a thing.

03. Basic version

The config device allows you to transfer data to your transponders and locking components. Your system is now ready for use.

04. Optional: online extension

In the online version, your networked locking components connect directly with the server via a SmartBridge. This ensures system equipment and authorisation changes are implemented almost in real time. Full control anywhere at any time.

05. Remote control key as an ID medium

Unlock without mechanical keys using a transponder, PinCode keypad or smartphone (online). It's that simple for you to change to the digital way of locking.

06. Locking components

Press the button and your wireless key transmits individual stored authorisations to the digital cylinders or a specially designed relay. Doors and gates will then open if the authorisation is valid.

Security takes top priority

Your data is stored on an audited SimonsVoss server in Munich, Germany. No need to worry about data security and data management: we will do it for you to the strictest of standards.

More information at:

www.simons-voss.com

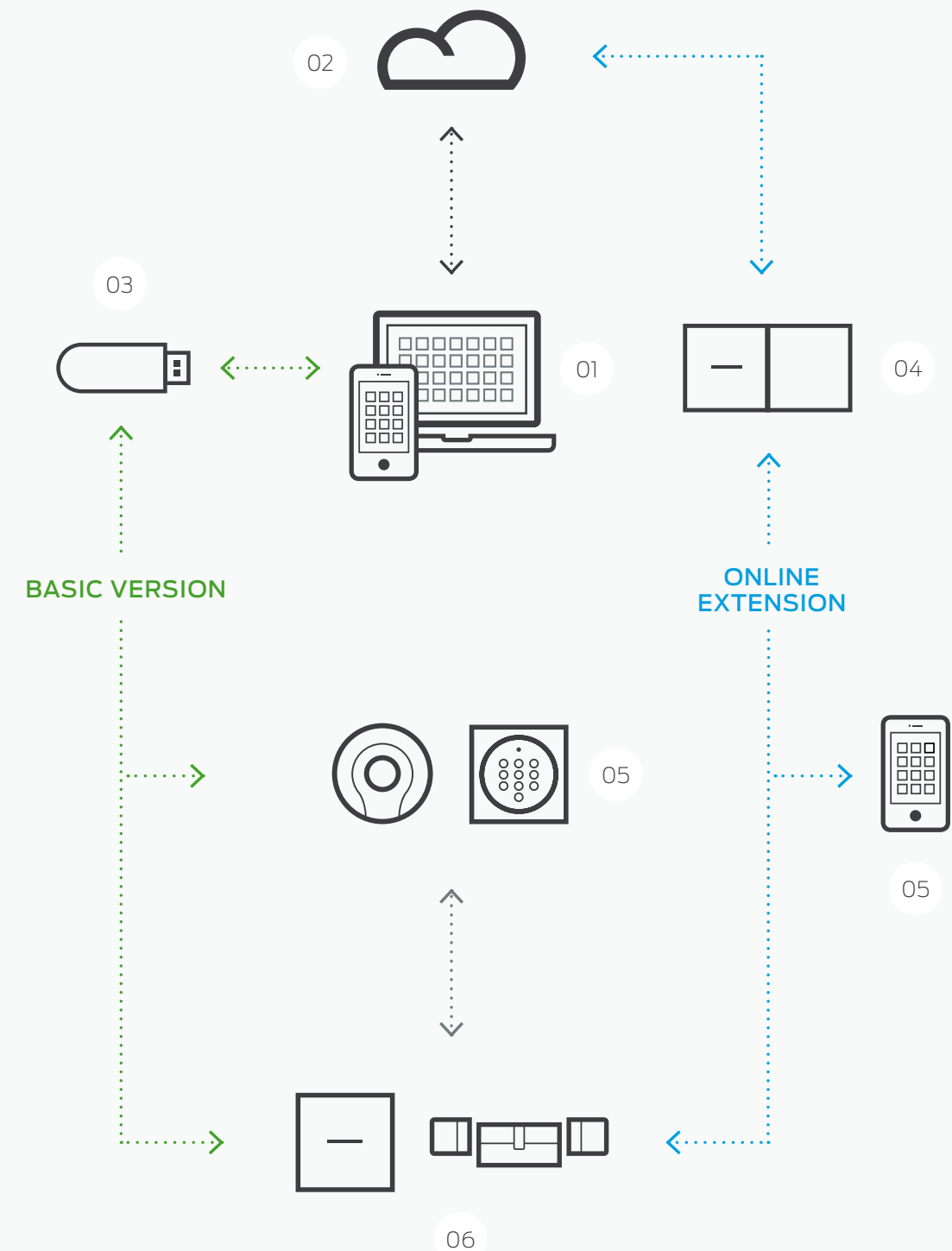

Transponders MobileKey

The transponder serves as an electronic key in the MobileKey system. Equipped with a high-performance battery, the transponder can activate up to 400,000 locking and unlocking procedures. The digital “key” contacts the electronic locking cylinder wirelessly. It will only activate if the authorisation is valid. If lost, the transponder can be disabled instantly – a new one can be configured as required at the click of the mouse .

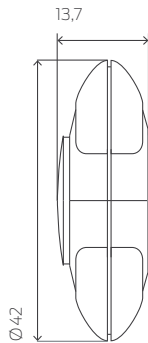

Measurements indicated in mm

Technical specifications

- ❖ Housing made of black polyamide
- ❖ Dimensions: 42 x 13.7 mm (Ø x H)
- ❖ Protection rating: IP 65
- ❖ Typical read range: up to 40 cm to the locking cylinder
- ❖ Battery type: 1 x CR2032, 3 V, lithium
- ❖ Battery life:
 - up to 400,000 activations or up to ten years on stand-by
- ❖ Temperature range: -25 °C to +65 °C
- ❖ Environmental class: III
- ❖ For up to 4 locking systems MobileKey or System 3060 (G2)

Description	Order code
Transponder MobileKey with blue button	MK.TRA2.G2
Switching transponder with 2 connection wires to activate it via an isolated contact	TRA2.G2.SCHALT

PinCode keypad MobileKey

Open your doors with a 4- to 8-digit code. You can fit the ultra-slim PIN code keypad indoors or outdoors without any cabling and even mount it on glass. Save time and costs when events such as seminars and evening meetings, for example, by issuing a special code for the entrance door.

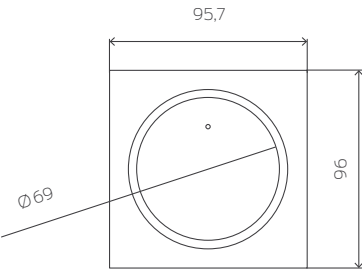

Measurements indicated in mm

Technical specifications

- ❖ Silver-coloured ABS plastic housing
- ❖ Dimensions: 96 x 95.7 x 14 mm (H x W x D)
- ❖ Weight: about 100 g including batteries
- ❖ Protection rating: IP 65
- ❖ Typical read range: up to 40 cm to the locking cylinder/SmartHandle; up to 120 cm to SmartRelay
- ❖ Battery type: 2 x CR2032, 3 V, lithium
- ❖ Battery life: up to 100,000 activations or up to ten years on stand-by
- ❖ 2-level battery warning system
- ❖ Temperature range: -25 °C to +65 °C
- ❖ Manipulation alarm
- ❖ Number of keypad users: 3 different PINs
- ❖ Cable-free surface mount

Description	Order code
PinCode keypad MobileKey	MK.TRA.PINCODE

Measure and select the right locking cylinder.

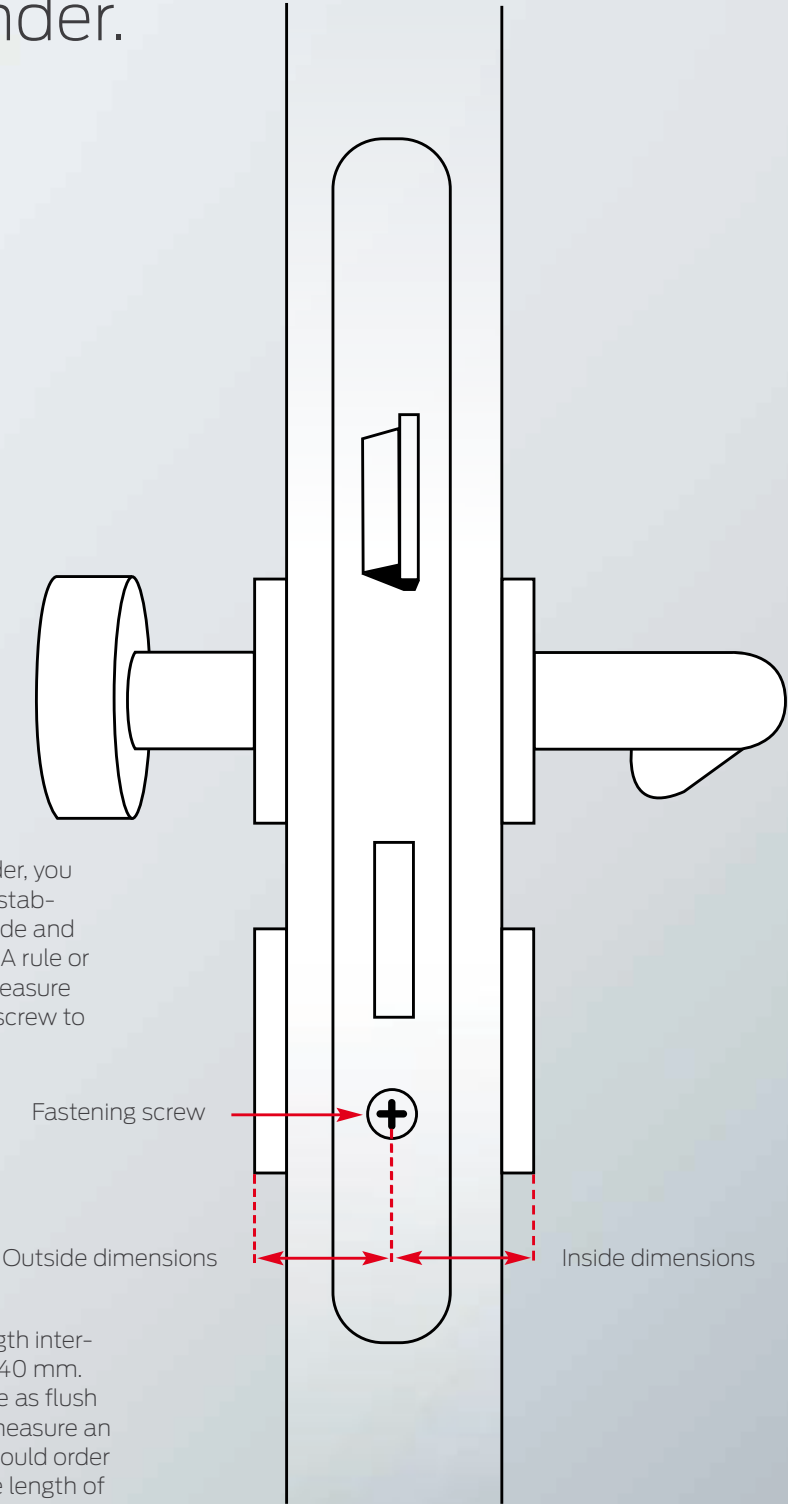

Before ordering the locking cylinder, you need to take measurements to establish the required cylinder size. Inside and outside dimensions are required. A rule or measuring template is used to measure from the centre of the fastening screw to the end of the inlay.

The cylinders are available in length intervals of 5 mm. for example, 35 or 40 mm. The cylinder housing should close as flush as possible. For example, if you measure an external length of 38 mm, you should order a locking cylinder with an outside length of 40 mm.

If the external dimension is 40 mm and the inside dimension 35 mm, these measurements become part of the order code: MK.Z4.40-35.FD.FH.ZK.G2.

Digital Euro Profile Double Thumb-turn Cylinder MobileKey

The locking cylinder – your digital lock. Fast, cable-free installation with no drilling and a beautifully shaped design: the all-rounder for a large number of applications.

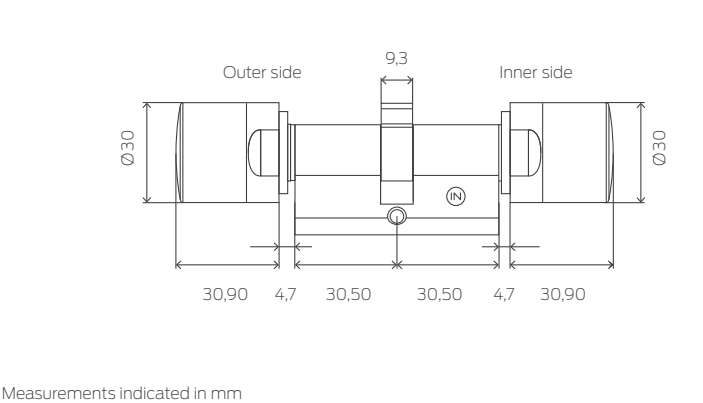

Technical specifications

- Standard Euro Profile cylinder as per DIN 18252 / EN 1303 / DIN EN 15684, stainless steel design, freely rotating on both sides
- Thumb-turn diameter: 30 mm
- Basis installation length: 30 – 30 mm (outer/inside dimension)
- Overall length: up to max. 140 mm (max. 90 mm on one side), at no extra charge
- Protection rating: IP 54; weatherproof version: IP 66
- Battery type: 2 x lithium, CR2450, 3 V
- Battery life: up to 300,000 locking operations or up to ten years on standby
- Temperature range: Operational: -25 °C to +65 °C
In storage: -35 °C to +50 °C
- 500 access events can be logged

Product versions	Order code
Digital Euro Profile Double Thumb-turn Cylinder MobileKey – FD freely rotating on both sides; with access control; time zone control and logging; stainless steel design Version with integrated LockNode for networking	MK.Z4.ee-ii.FD.FH.ZK.G2 MK.Z4.ee-ii.FD.FH.LN.ZK.G2
Multi-point version for use in doors with multi-point locks; installation length 35 – 30 mm and above Version integrated LockNode for networking	MK.Z4.ee-ii.FD.MR.FH.ZK.G2 MK.Z4.ee-ii.FD.MR.FH.LN.ZK.G2
Weatherproof version; protection rating: IP 66; installation length 30 – 35 mm and above, Version with integrated LockNode for networking	MK.Z4.ee-ii.FD.WP.FH.ZK.G2 MK.Z4.ee-ii.FD.WP.FH.LN.ZK.G2
Digital Euro Profile Double Thumb-turn Cylinder MobileKey – DoorMonitoring compact door monitoring; installation length 30 – 35 mm and above; freely rotating on both sides, LockNode integrated for networking; with access control, time zone control and event logging	MK.Z4.ee-ii.DM.FD.FH.ZK.G2
Intelligent fastening screw with sensors for use with the DoorMonitoring cylinder. You need to know the backset to order the fastening screw. Available in 5 mm increments, from 25 mm to max. 70 mm.	Z4.DM.xx.SCREW

Digital Euro Profile Double Thumb-turn Cylinder MobileKey – Button control

The same as the standard cylinder but with added button control, thus allowing the inner side to be opened without a transponder. Particularly suitable for external and access doors.

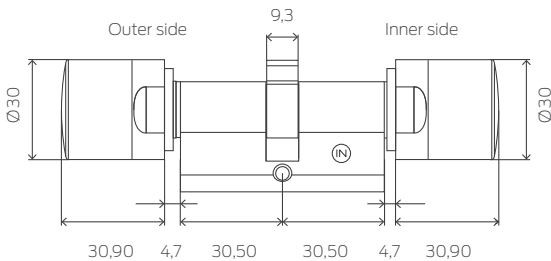

Measurements indicated in mm

Technical specifications

- Standard Euro Profile cylinder as per DIN 18252 / EN 1303 / DIN EN 15684
- Thumb-turn diameter: 30 mm
- Basic installation length: 30 – 30 mm (outer/inside dimension)
- Overall length: up to max. 140 mm (max. 90 mm on one side), at no extra charge
- Protection rating: IP 54
- Battery type: 2 x lithium, CR2450, 3 V
- Battery life: up to 300,000 locking operations or up to ten years on standby
- Temperature range: Operational: -25 °C to +65 °C In storage: -35 °C to +50 °C
- 500 access events can be logged

Product versions

Digital Euro Profile Double Thumb-turn Cylinder MobileKey – Button control
freely rotating on both sides; can be operated from inside without transponder; stainless steel design
Version with integrated LockNode for networking

Order code

MK.Z4.ee-ii.FD.TS.FH.ZK.G2

MK.Z4.ee-ii.FD.TS.FH.LN.ZK.G2

Multi-point version for use in doors with multi-point locks; installation length 35 – 30 mm and above
Version with integrated LockNode for networking

MK.Z4.ee-ii.FD.TS.MR.FH.ZK.G2

MK.Z4.ee-ii.FD.TS.MR.FH.LN.ZK.G2

Digital Euro Profile Double Thumb-turn Cylinder MobileKey – DoorMonitoring
compact door monitoring; with button control; installation length 30 – 35 mm and above; freely rotating on both sides; integrated LockNode for networking; with access control, time zone control and logging

MK.Z4.ee-ii.DM.FD.TS.FH.ZK.G20

Intelligent fastening screw with sensors for use with the DoorMonitoring cylinder. You need to know the backset to order the fastening screw. It can be ordered in 5 mm increments between 25 mm and 70 mm.

Z4.DM.xx.SCREW

Digital Euro Profile Double Thumb-Turn Cylinder MobileKey – Anti-panic

The anti-panic cylinder has been specially developed for use along escape and rescue routes. The AP cylinder is freely rotating on both sides, so that the lock can be locked and unlocked from both sides using an authorised transponder. In a panic situation, however, the door can be opened without a transponder using the anti-panic lock function. It may only be fitted into locks which list the cylinder in their approval.

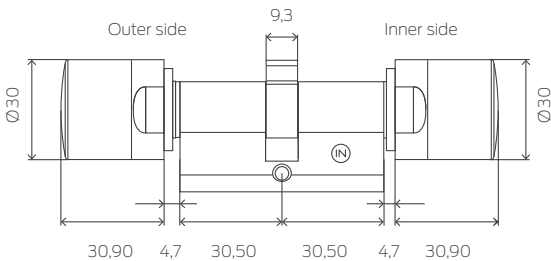

Measurements indicated in mm

Technical specifications

- Euro Profile Anti-panic cylinder as per DIN 18252 / EN 1303 / DIN EN 15684
- Thumb-turn diameter: 30 mm
- Basis installation length: 30 – 30 mm (outer/inside dimension)
- Overall length: up to max. 140 mm (max. 90 mm on one side), at no extra charge
- Protection rating: IP 54
- Battery type: 2 x lithium, CR2450, 3 V
- Battery life: up to 300,000 locking operations or up to ten years on standby
- Temperature range: Operational: -25 °C to +65 °C In storage: -35 °C to +50 °C
- 500 access events can be logged

Product versions

Digital Euro Profile Double Thumb-turn Cylinder MobileKey – Anti-panic
For use in anti-panic locks, freely rotating on both sides, stainless steel design
Version with integrated LockNode for networking

Order code

MK.Z4.aa-ii.AP2.FD.FH.ZK.G2

MK.Z4.aa-ii.AP2.FD.FH.LN.ZK.G2

Weatherproof version; protection rating: IP 66

MK.Z4.aa-ii.AP2.FD.FH.WP.ZK.G2

Version with integrated LockNode for networking

MK.Z4.aa-ii.AP2.FD.FH.WP.LN.ZK.G2

Digital Euro Profil Double thumb-turn cylinder MobileKey – Anti-panic – DoorMonitoring; Suitable for doors which require extra surveillance, installation length 30 – 35 mm and above, freely rotating on both sides, with integrated LockNode for networking, includes access control, time zone management and events logging, without bolt detection; applicable in all typical multi point locks

MK.Z4.aa-ii.DM.AP2.FD.FH.ZK.G2

Digital Euro Profil Double thumb-turn cylinder MobileKey – Anti-panic – DoorMonitoring; Version as described above, but with button control

MK.Z4.aa-ii.DM.AP2.FD.TS.FH.ZK.G2

Digital Euro Profile Double Thumb-turn Cylinder MobileKey – Comfort

Comfort cylinder (can be operated on the inner side without a transponder as the thumb turn is permanently engaged ready for use)

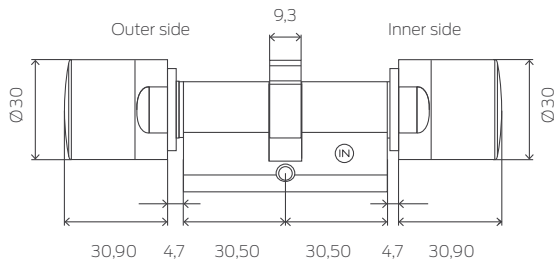

Measurements indicated in mm

Technical specifications

- Standard Euro Profile cylinder as per DIN 18252 / EN 1303 / DIN EN 15684
- Thumb-turn diameter: 30 mm
- Basic installation length: 30 – 30 mm (outer/inside dimension)
- Overall length: up to max. 140 mm (max. 90 mm on one side), at no extra charge
- Protection rating: IP 54
- Battery type: 2 x lithium, CR2450, 3 V
- Battery life: up to 300,000 locking operations or up to ten years on standby
- Temperature range: Operational: -25 °C to +65 °C In storage: -35 °C to +50 °C
- 500 access events can be logged

Product versions

Digital Euro Profile Double Thumb-turn Cylinder MobileKey – Comfort
Non-electronics side is permanently engaged and can therefore be operated from the inner side without a transponder; stainless steel design
Version with integrated LockNode for networking

Order code

MK.Z4.ee-ii.CO.ZK.G2

MK.Z4.ee-ii.CO.LN.ZK.G2

MK.Z4.ee-ii.CO.WP.ZK.G2
MK.Z4.ee-ii.CO.WP.LN.ZK.G2

Weatherproof version; protection rating: IP 66;
installation length 35 – 30 mm
Version with integrated LockNode for networking

Digital Euro Profile Half cylinder MobileKey

You can acquire the digital locking cylinder in a wide variety of versions, including a half cylinder. It offers you a solution for all door installation types in outdoor areas, such as in garage doors or key switches.

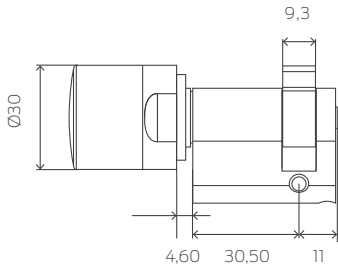

Measurements indicated in mm

Technical specifications

- Standard Euro Profile cylinder as per DIN 18252 / EN 1303 / DIN EN 15684
- Thumb-turn diameter: 30 mm
- Basic installation length: 30 – 10 mm (outer/inside dimension) At no extra charge
- Overall length: up to max. 140 mm (max. 90 mm on one side), at no extra charge
- Protection rating: IP 66
- Battery type: 2 x lithium, CR2450, 3 V
- Battery life: up to 300,000 locking operations or up to ten years on standby
- Temperature range: Operational: -25 °C to +65 °C In storage: -35 °C to +50 °C
- 500 access events can be logged

Product versions

Digital Euro Profile half cylinder MobileKey, weatherproof version;
protection rating: IP 66 (Thumb-turn); Thumb-turn cannot be detached;
stainless steel design
Version with integrated LockNode for networking

Order code

Multi-point design; detachable Thumb-turn; weatherproof version;
Protection rating: IP 66 (Thumb-turn)
Version with integrated LockNode for networking

MK.Z4.ee-10.HZ.WP.ZK.G2

MK.Z4.ee-10.HZ.WP.LN.ZK.G2

MK.Z4.ee-10.HZ.MR.WP.ZK.G2
MK.Z4.ee-10.HZ.MR.WP.LN.ZK.G2

Digital Scandinavian Oval Cylinder MobileKey

The locking cylinder can also be delivered for doors with Scandinavian Oval Profile.

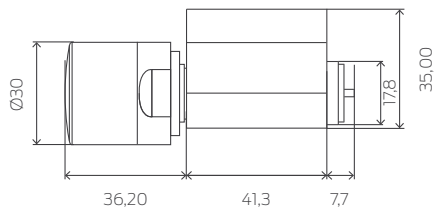

Measurements indicated in mm

Technical specifications

- ❖ Scandinavian Oval Profile Cylinder
- ❖ Diameter: 30 mm
- ❖ Basic installation length: in the version for the outer side: 41.3 mm; in the version for the inner side: 30 mm
- ❖ Overall length: max. 86.3 mm; special lengths on request
- ❖ Protection rating: inner thumb-turn: IP54; weatherproof version of cylinder for the outer side: IP66
- ❖ Battery type: 2 x lithium, CR2450, 3V
- ❖ Battery life: up to 300,000 lock operations or up to ten years on standby
- ❖ Temperature range: Operational: -25 °C to +65 °C
In storage: -35 °C to +50 °C
- ❖ 500 access events can be logged

Product versions	Order code
Digital Scandinavian Oval Cylinder for the outer side, installation length: 41.3 mm; stainless steel design Version with integrated LockNode for networking	MK.Z4.SO.A40.ZK.G2 MK.Z4.SO.A40.LN.ZK.G2
Digital Scandinavian Oval Cylinder for the outer side, Weatherproof version, installation length: 41.3 mm; stainless steel design Version with integrated LockNode for networking	MK.Z4.SO.A40.WP.ZK.G2 MK.Z4.SO.A40.WP.LN.ZK.G2
Digital Scandinavian Oval Cylinder, for the inner side	Z4.SO.I30

Digital Swiss Round Double Thumb-turn Cylinder MobileKey – Comfort

Digital locking cylinder for doors with a Swiss Round Profile.

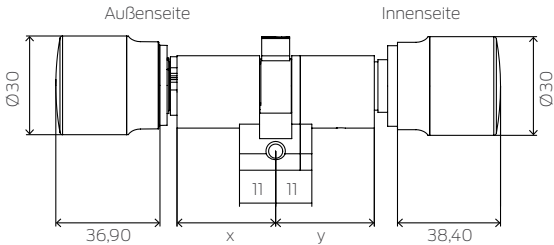

Measurements indicated in mm

Technical specifications

- ❖ Swiss Round Cylinder as per DIN 18252 / EN 1303 / DIN EN 15684, stainless steel design, inner thumb-turn can be operated without transponder
- ❖ Thumb-turn diameter: 30 mm
- ❖ Basic installation length: 30 – 30 mm (outer/inside dimension)
- ❖ Overall length: up to max. 140 mm (max. 90 mm on oneside), at no extra charge
- ❖ Protection rating: IP 54, weatherproof version: IP 66
- ❖ Battery type: 2 x lithium, CR2450, 3V
- ❖ Battery life: up to 300,000 lock operations or up to ten years on standby
- ❖ Temperature range: Operational: -25 °C to +65 °C
In storage: -35 °C to +50 °C
- ❖ 500 access events can be logged

Product versions	Order code
Digital Swiss Round Double Thumb-turn Cylinder MobileKey – Comfort, inside thumb-turn can be operated without transponder, includes access control, time zone management and events logging, stainless steel design Version with integrated Lock Node for networking	MK.Z4.SR.aa-ii.CO.ZK.G2 MK.Z4.SR.aa-ii.CO.LN.ZK.G2
Weatherproof version, protection rating IP 66, installation length 30 – 35 mm and above Version with integrated Lock Node for networking	MK.Z4.SR.aa-ii.CO.WP.ZK.G2 MK.Z4.SR.aa-ii.CO.WP.LN.ZK.G2

Digital Swiss Round Half Cylinder MobileKey

Suitable e.g. for garage doors or use with key-operated switches.



Measurements indicated in mm

Technical specifications

- ❖ Swiss Round half cylinder as per DIN 18252 / EN 1303 / DIN EN 15684
- ❖ Detachable thumb-turn
- ❖ Thumb-turn diameter: 30 mm
- ❖ Multi-point version: 35 – 10 mm
- ❖ Basic installation length: 30 – 10 mm
- ❖ Overall length: up to max. 100 mm (max. 90 mm on one side), at no extra charge
- ❖ Protection rating: IP 66
- ❖ Battery type: 2 x lithium, CR2450, 3 V
- ❖ Battery life: up to 300,000 locking operations or up to ten years on standby
- ❖ Temperature range: Operational: -25 °C to +65 °C
In storage: -35 °C to +50 °C
- ❖ 500 access events can be logged

Product versions

Digital Swiss Round Half Cylinder MobileKey, Weatherproof version, protection rating IP 66 (thumb-turn), detachable thumb-turn, stainless steel design
Version with integrated LockNode for networking

Multi-point version, detachable thumb-turn, Weatherproof version

Version with integrated LockNode for networking

Order code

MK.Z4.SR.aa-10.HZ.WP.ZK.G2

MK.Z4.SR.aa-10.HZ.WP.LN.ZK.G2

MK.Z4.SR.aa-10.HZ.MR.WP.ZK.G2

MK.Z4.SR.aa-10.HZ.MR.WP.LN.ZK.G2



Digital SmartRelay MobileKey

The Digital SmartRelay acts as an access control reader or key switch. In the MobileKey system, it opens electrically opened doors, gates and barriers and switches lighting, heating and machines.



USB programming device MobileKey

The small, compact USB programming device allows operators of small and extremely small lock systems to have absolute control over their lock system. It enables them to create a locking system, programme components and manage access authorisations. The USB programming device is provided together with an easy-to-use MobileKey web application.



Technical specifications

- ❑ Housing made of white polyamide 6.6
Dimensions: 78 x 78 x 19 mm (H x W x D)
- ❑ Housing made of black plastic (polyamide 6.6)
Dimensions: 55.4 x 71.8 x 25.1 mm (H x W x D)
- ❑ Protection rating: IP 20, not suitable for unprotected use outdoors
- ❑ Typical read range: up to 120 cm
- ❑ Temperature range: Operational: -22 °C to +55 °C
- ❑ Air humidity: < 95 % without condensation
- ❑ Circuit board dimensions: 50 x 50 x 14 mm (H x W x D)
- ❑ Mains voltage: 12 V AC (for SREL only) or 5-24 V DC
- ❑ Power limitation: mains adapter must be limited to 15 VA
- ❑ Standby current: < 5 mA
- ❑ Max. current: < 100 mA
- ❑ Pulse duration can be programmed between 0.1 and 25.5 sec.
- ❑ Battery operation optional (MK.SREL.ZK.G2)
- ❑ 500 access events can be logged

Technical specifications for output relay

- ❑ Type: changeover contact; in SREL2: normally open contact invertible
- ❑ Continuous current: max. 1.0 A
- ❑ Switch-on current: max. 2.0 A
- ❑ Switching voltage: max. 24 V
- ❑ Switching power: 10⁶ activations at 24 VA

Technical specifications

- ❑ Programming: SimonsVoss 25 kHz technology
- ❑ Operating system: Windows 7 and higher
- ❑ USB port: USB type A (same as a flash memory)/USB 2.0
- ❑ Power supply: USB connector

- ❑ Dimensions: 57 (70) x 19 x 13 mm (L x W x H)
- ❑ Programming distance: 10-30 cm
- ❑ Protection rating: IP 40
- ❑ Temperature range: -10 °C to +60 °C
- ❑ Humidity: 95% (non-condensing)

Product versions

Digital SmartRelay MobileKey in white design housing for surface mount; with access control, time zone management and events logging; no connection for external antenna.
Version with integrated LockNode suitable for networking

Order code

MK.SREL2.ZK.G2.W

MK.SREL2.LN.ZK.G2.W

Digital SmartRelay MobileKey in black housing also suitable for flush-fit; with access control, time zone control and event logging; connection possible for external antenna.

MK.SREL.ZK.G2

Description

USB programming device to programme MobileKey products. Connection to a PC via USB port in conjunction with MobileKey web application

Order code

MK.CD.STARTER.G2

Kits with the complete MobileKey range

We also offer MobileKey components in affordable starter kits for new users.

MobileKey Starter Set 1

Consisting of 3 transponders (MK.TRA2.G2) and 1 USB config device (MK.CD.STARTER.G2)

Order code

MK.SET1

MobileKey Starter Set 2

Consisting of 3 transponders (MK.TRA2.G2) 1 PinCode keypad (MK.TRA .PINCODE) and 1 USB config device (MK.CD.STARTER.G2)

Order code

MK.SET2



Online extension MobileKey

In the online version, your digital locking cylinder is directly connected to the server via a SmartBridge. This allows you to install system equipment and make changes to authorisations almost in real time. Full control anywhere at any time.



Technical specifications

- ⌘ Housing made of ABS plastic, UV-stable; colour: 9/118645, same as RAL 9016 (Traffic white)
 - ⌘ Dimensions: 172 x 86 x 33 mm (LxWxH)
 - ⌘ Radio frequency: 868.xx – 870 MHz
 - ⌘ Output: max. 3 VA
 - ⌘ Range up to 30 m
- ⌘ Radio module transmission power: 10 dBm (6.3 mW) to the antenna socket
 - ⌘ External power supply: regulated mains adapter 9-24 V DC: MK.SMARTBRIDGE.ER also PoE-capable (802.3af)

Description

MobileKey SmartBridge to network MobileKey locking devices with the SimonsVoss server. Ethernet design to connect with a network node

Order code

MK.SMARTBRIDGE.ER0

What goes with it

Description	Order code
Intelligent fastening screw with sensors for use with the DoorMonitoring cylinder. IMPORTANT: you need to know the backset to order the intelligent fastening screw. Available in 5 mm increments, from 25 mm to max. 70 mm.	Z4.DM.xx.SCREW
Special mounting screwdriver for DoorMonitoring	Z4.DM.SCREWDRIVER
Installation/battery key: Special tool for disassembly and battery replacement (button cells) in TN4 cylinders (double thumb-turn cylinders and half cylinders)	Z4.SCHLUESSEL
Core protection adapter for all freely-rotating TN4 double thumb-turn cylinders; (note: take extension into account for the cylinder's external dimensions) 8 mm extension 15 mm extension 20 mm extension	Z4.KA Z4.KA.15R Z4.KA.20R
5 batteries for MobileKey transponder (type: CR2032)	TRA.BAT
10 batteries for MobileKey cylinders (double thumb-turn and half cylinders) (type: CR2450)	Z4.BAT.SET
Battery for SmartRelay in black housing (MK.SREL.ZK.G2), for operating without external power supply (e.g. as door strike), Battery type: lithium 1/2 AA	SREL.BAT
External antenna for connecting Smart Relay; cable 5 m long	SREL.AV
Protective housing for SmartRelay (SREL2) for use outdoors	SREL.COVER1
External plug-in power supply (Europlug) for SmartBridge (suitable for use with MK.SREL/MK.SREL2)	POWER.SUPPLY.2
External plug-in power (universal plug EU, US, UK, AU) for SmartBridge (suitable for use with MK.SREL/MK.SREL2)	POWER.SUPPLY.2.UNI
External antenna set for SmartBridge	ANTENNA.EXT.868
MobileKey Network thumb-turn Cover as a replacement part for networking cylinders directly	MK.LN.I
MobileKey network circuit board as a replacement part for networking SmartRelay (SREL2) directly	MK.LN.I.SREL2.G2
Empty sample box (aluminium box 327 x 200 x 54) for 1 cylinder in installation length 35 – 35 mm, 2 transponders, 1 PinCode keypad, 1 USB config device	MK.KOFFER.SMALL.U

This price list is valid until a new SimonsVoss Technologies GmbH price list is issued. The stated prices are EXW Osterfeld and are subject to shipping costs and the applicable sales tax. A surcharge of 25 euros applies for quantities below a minimum order value of 50 euros. Our general terms and conditions of business apply in their current version, which can be sent to you upon request. You will find SimonsVoss Technologies GmbH's terms and conditions of business in the Legal Information section online at www.simons-voss.com.

A bespoke locking system in just a few steps.



- 01. Establish what components are required**
First, define your group of users and thus establish the number of ID media required. Then specify how many doors you wish to fit with locking components. Next indicate the locking cylinder lengths and functions.
- 02. Create the locking plan on www.simons-voss.com**
Register on www.simons-voss.com to activate your user account. You will then have access to the locking plan on all your Internet-ready devices. Now use the set-up agent to create the locking plan and enter component identifiers and characteristics. You can add more keys and locks whenever you like.
- 03. Programme the components**
You can start programming as soon as the individual components have been added and the access rights for the locking components have been issued. You can use the programming device to complete programming tasks directly on any Windows computer or Android smartphone. You can also use the online extension to programme locking components directly over the network.
- 04. Fit the components**
Once the programming process is complete, you fit the locking cylinders and also SmartRelays to activate barriers, garage doors and other such installations.
- 05. A short functions test and you are finished!**
After a short functions test the electronic lock system is ready for operation! You can change authorisations and extend your system whenever you like.

SimonsVoss Technologies GmbH
Feringastrasse 4
85774 Unterföhring
Germany
Tel. +49 89 99228-0
Fax +49 89 99228-222
info@simons-voss.com
www.simons-voss.com

Simons  Voss
technologies

© Copyright 2018, SimonsVoss Technologies GmbH, Unterföhring, Germany
All rights are reserved. Text, images and diagrams are protected under copyright law. The contents of this brochure must not be copied, distributed or modified. You can find authoritative, detailed technical information in the system manual. Subject to technical changes. SimonsVoss and MobileKey are registered brands belonging SimonsVoss Technologies GmbH.

About Allegion™

Allegion (NYSE: ALLE) is a global pioneer in the security sector with leading brands such as CISA®, Interflex®, LCN®, Schlage®, SimonsVoss® and Von Duprin®. Allegion focuses on security for doors and entrance areas, offering a wide variety of solutions for private households, companies, schools and other institutions. Allegion generates a turnover of 2 billion dollars every year and sells its products in almost 130 countries. For more information, visit www.allegion.com.

